

KEYBOARD TRAY

INSTRUCTION MANUAL

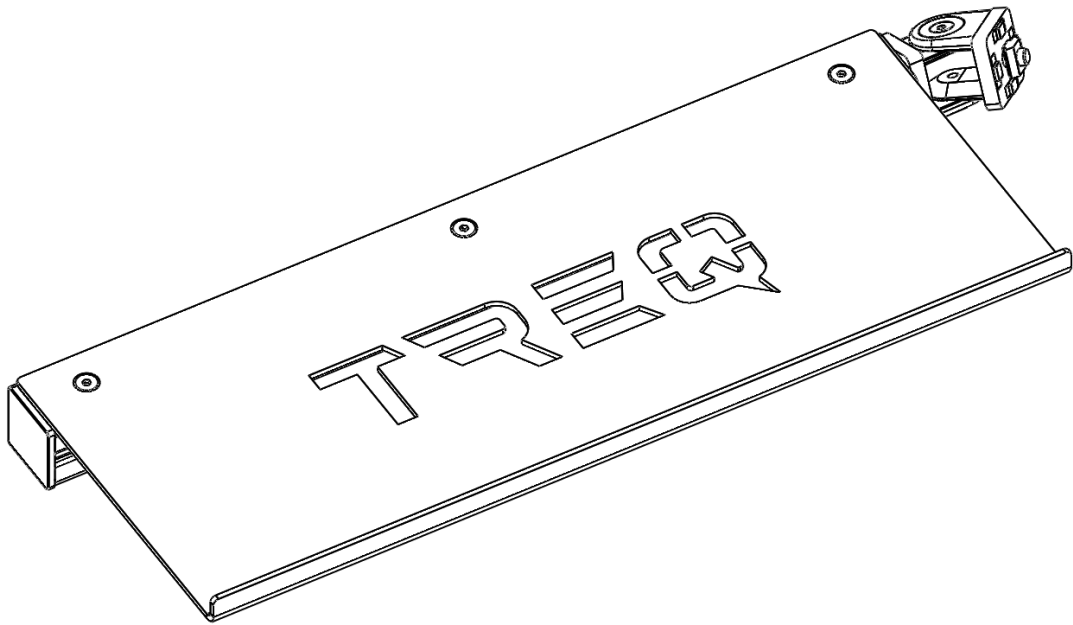

REQUIRED TOOLS:

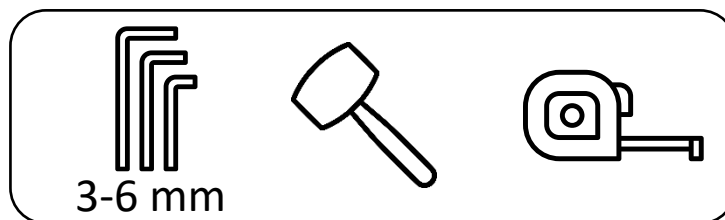

1

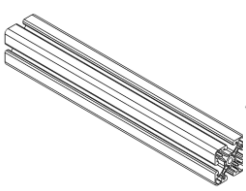

Profile 4040 L=500

1x

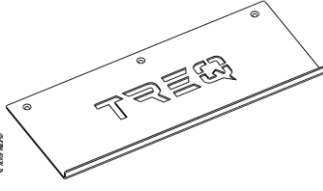

Tray

1x

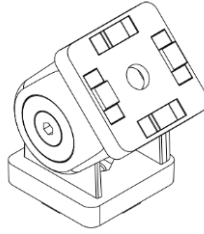

Hinge 4040

1x

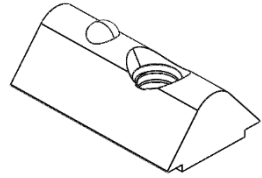

Click-in Nut M5

3x

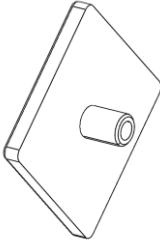

Cover 4040

1x

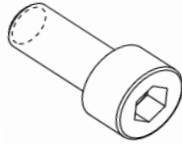

M8x16

2x

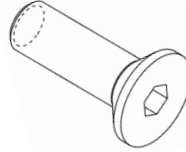

M5x12

3x

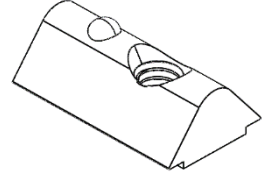

Click-in Nut M8

1x

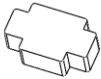

Cross

2x

2

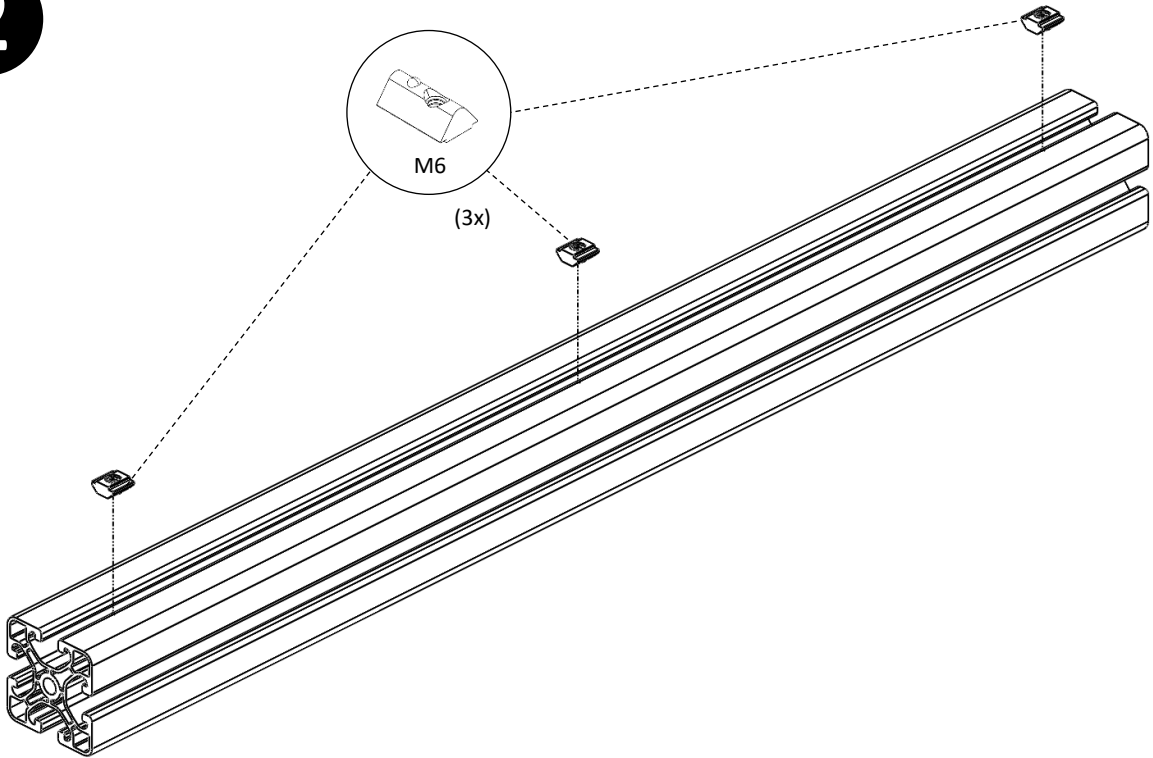

3

One side of the 4040 L=500 profile has a threaded M8 hole. This is the side where the hinge goes.

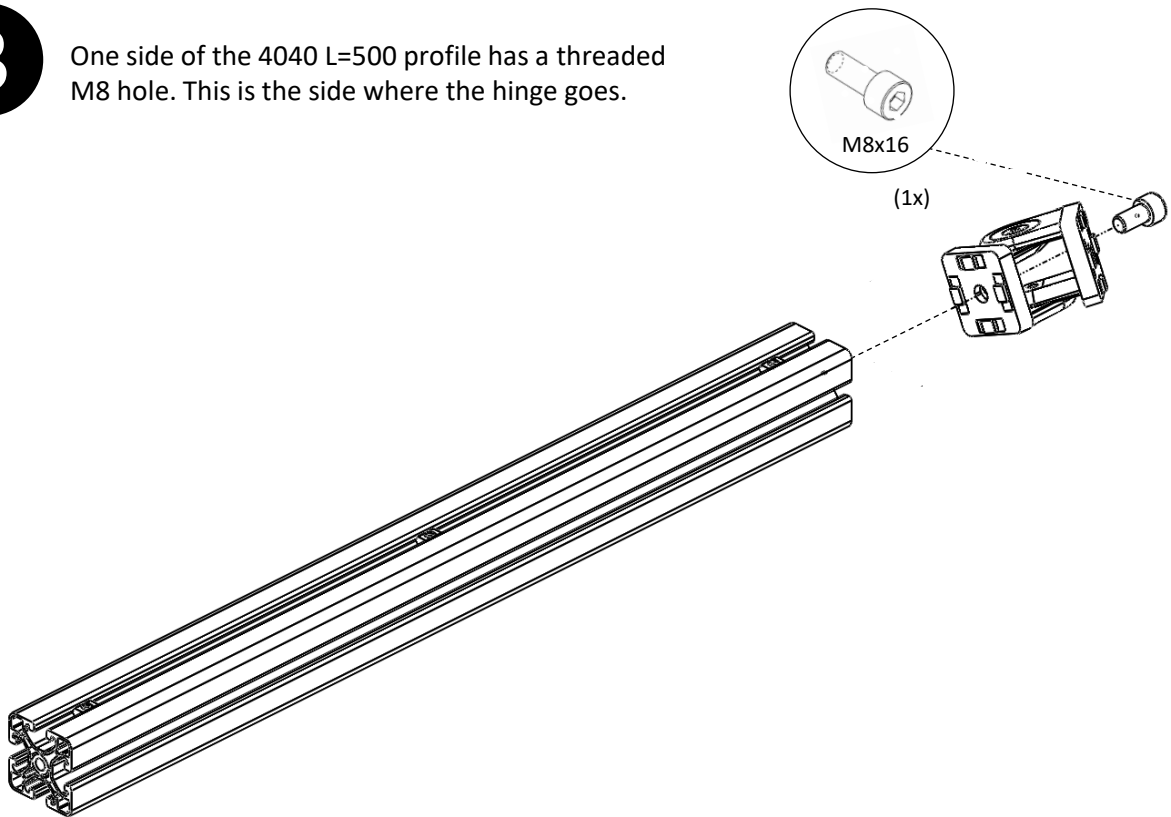

4

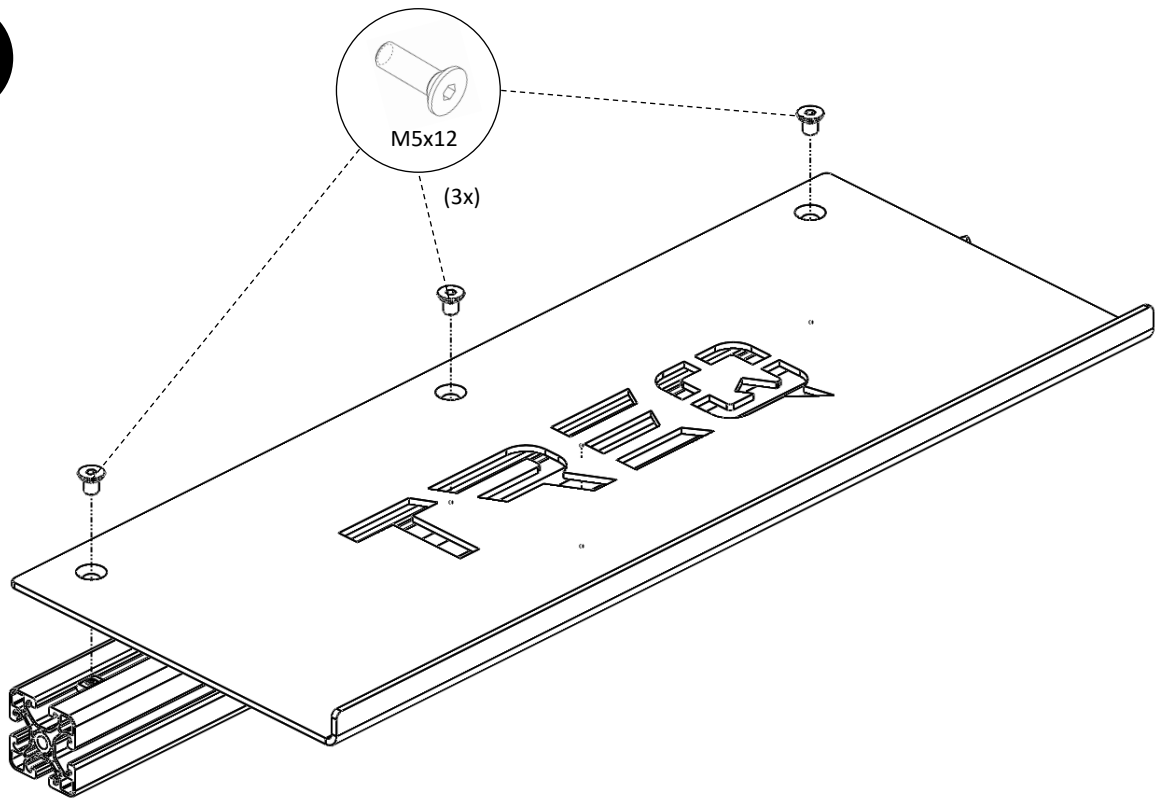

5

The hinge is delivered with at least 2 little 'crosses'. Place these with the 10mm side into the hinge. The 8mm side goes into the profile slot, and stops the hinge from rotating.

