

# HEEL REST

## INSTRUCTION MANUAL

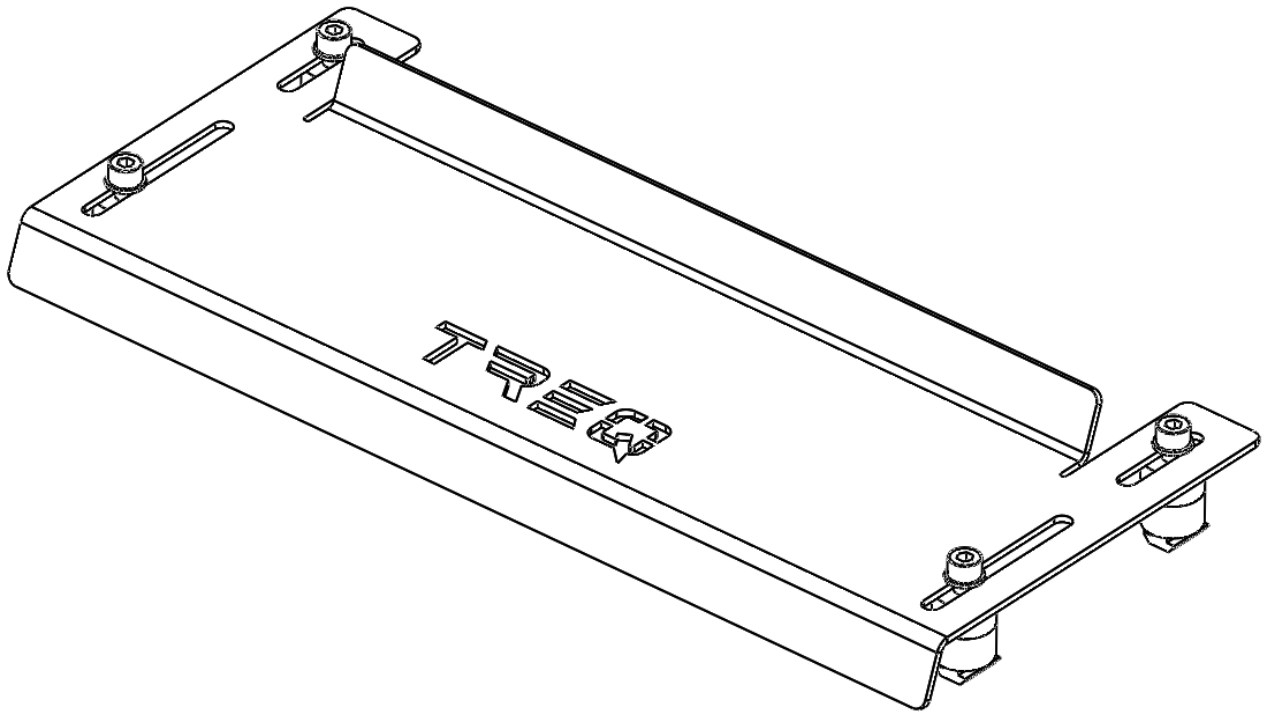

### REQUIRED TOOLS:

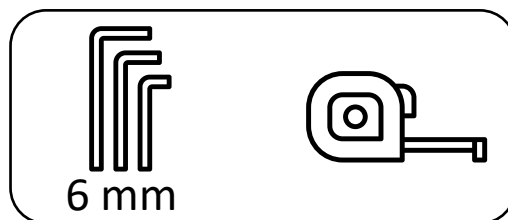

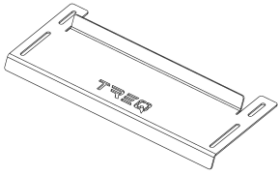
**1**

Plate

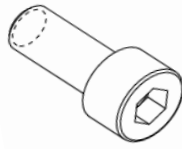
**1x**

M8x16 (Black)

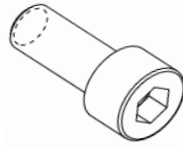
**4x**

M8x30 (Black)

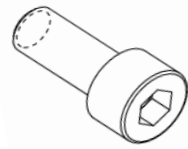
**4x**

M8x45 (Black)

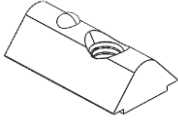
**4x**

Click-in Nut M8

**4x**

Washer M8

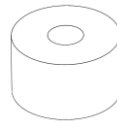
**4x**

Spacer 15mm

**8x****2**

Mount your Heel Rest like show in the drawing. All spacers are optional.

- 0mm height: Use **M8x16** and 0 spacers
- 15mm height: Use **M8x30** and 1 spacer on each corner.
- 30mm height: Use **M8x45** and 2 spacers on each corner.

